

Tools Required:

3/4" Standard Socket

3/8" Drive Ratchet

3/4" Combination End Wrench

DOUBLE HALF RACK ASSEMBLY INSTRUCTIONS
SINGLE & DOUBLE POST

Models:

- 400115
- 400115SB
- 400116
- 400116SB
- 400215
- 400215SB
- 400216
- 400216SB
- 700105
- 700105SB
- 700106
- 700106SB
- 700115
- 700115SB
- 700116
- 700116SB
- 700155
- 700156
- 700205
- 700206
- 700215
- 700216
- 700256

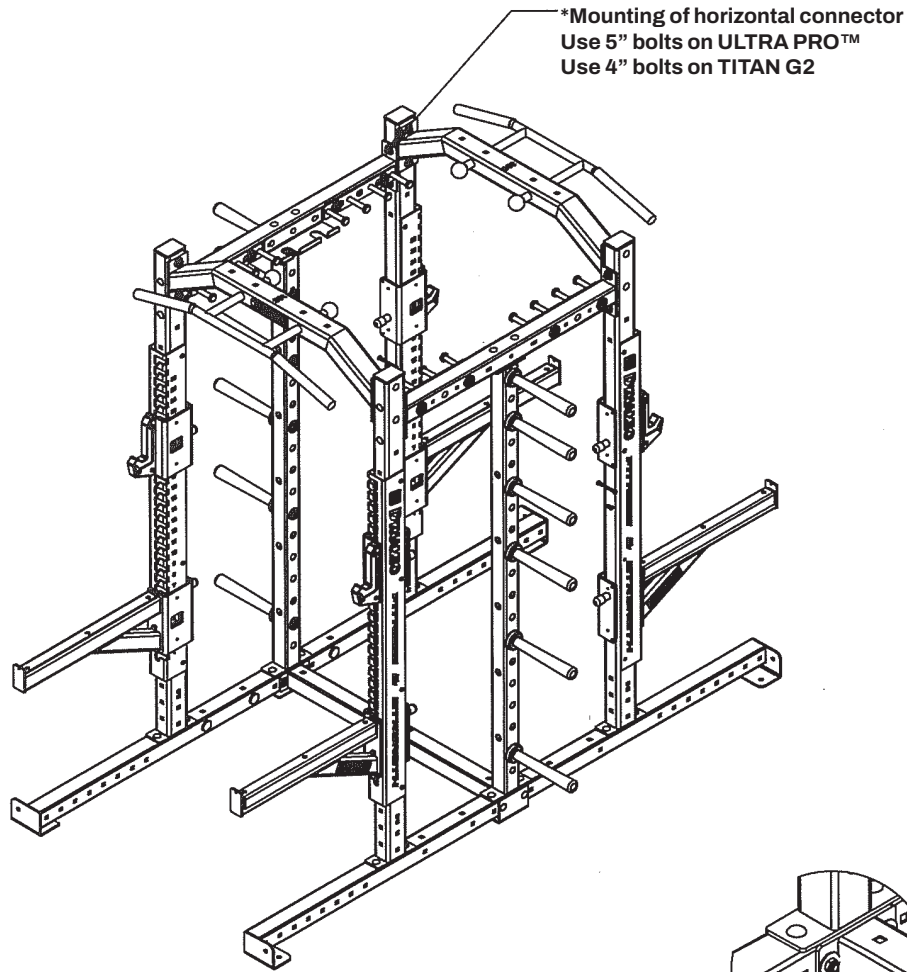

ULTRA PRO™

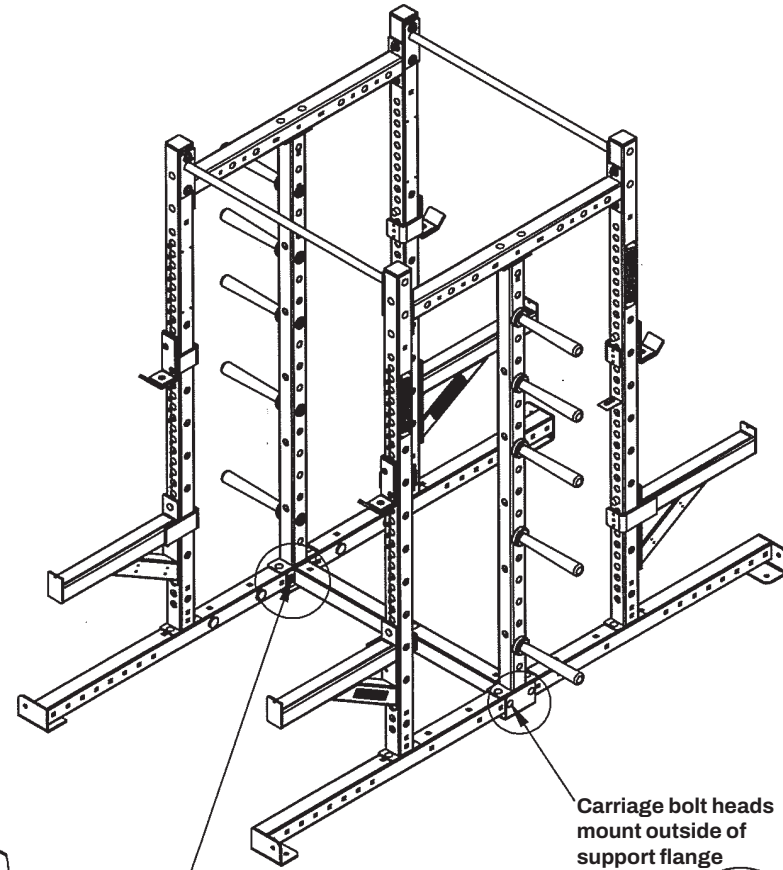

TITAN G2

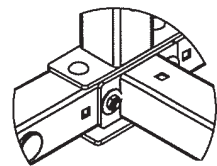

(4) Low Profile Jam Nuts used at this location only.

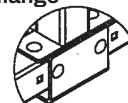

Before assembling this rack:

Consider how much space will be required around the unit to access weights and not interfere with other equipment.

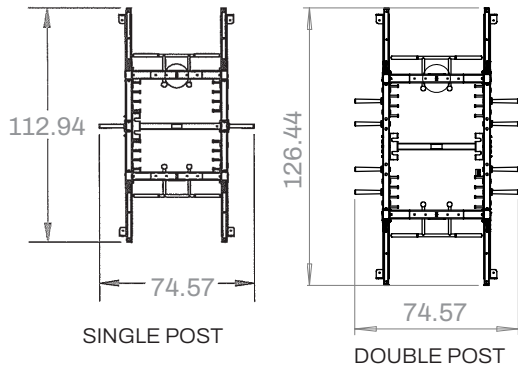

All parts have a part number. Position the part number to be covered by its mating component or up as shown in this view.

Carriage bolt head will lock into mounting flange of upright tube

Mount in locations (6) & (7) from end of base tube

TITAN G2
ULTRA PRO™

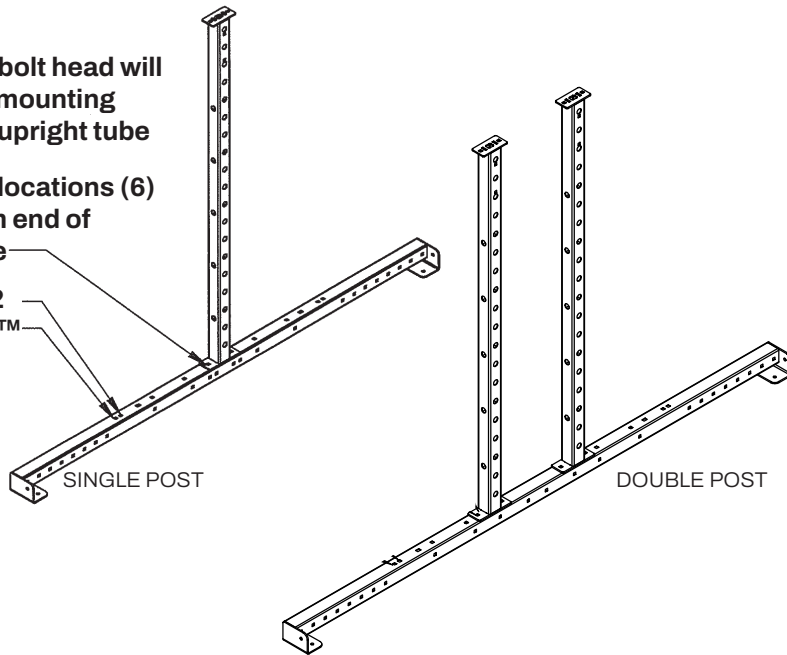

Step 1

Attach storage post to base as shown using carriage bolts. Install bolts into storage post flange and then through base tube. Bolt head on top of flange with nut mounted under base tube. To ease assembly lay the rack components out horizontally on the floor. Repeat for left side.

The mounting access for bar catch and safety must be to inside of rack as shown.
Note: Titan G2 Series will not have an upright wrap as shown.

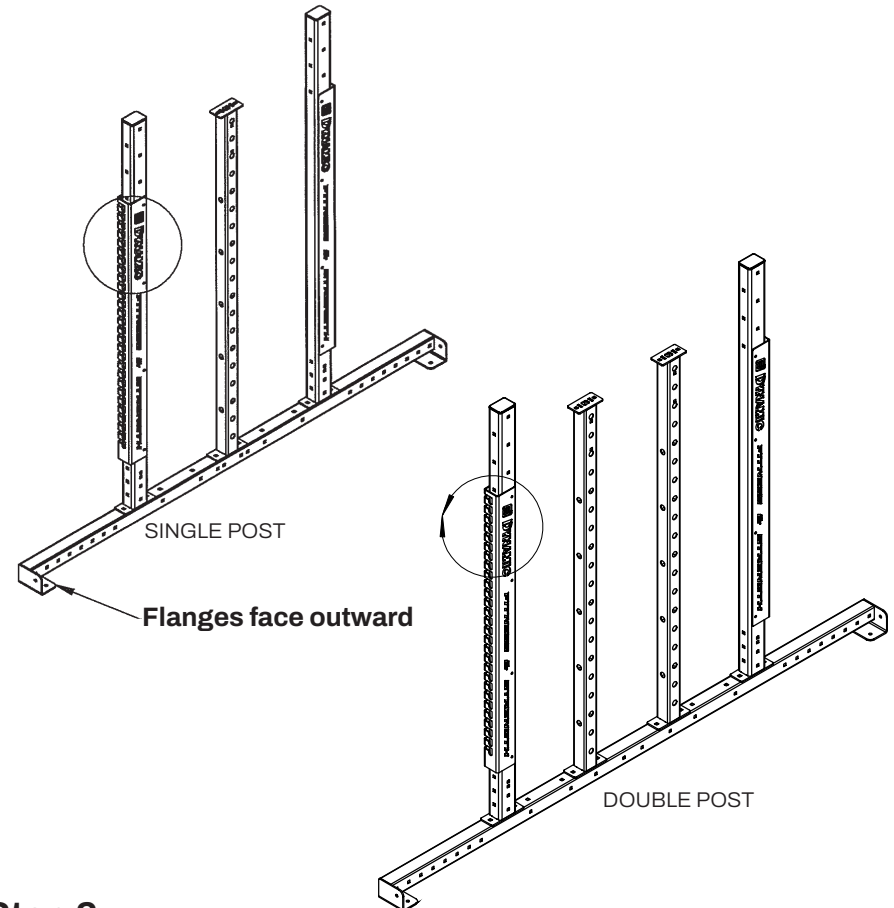

Step 2

Attach working uprights to right base as shown. ULTRA PRO™ will mount at first location from end of base tube TITAN G2 will mount at second location. Repeat for left side.

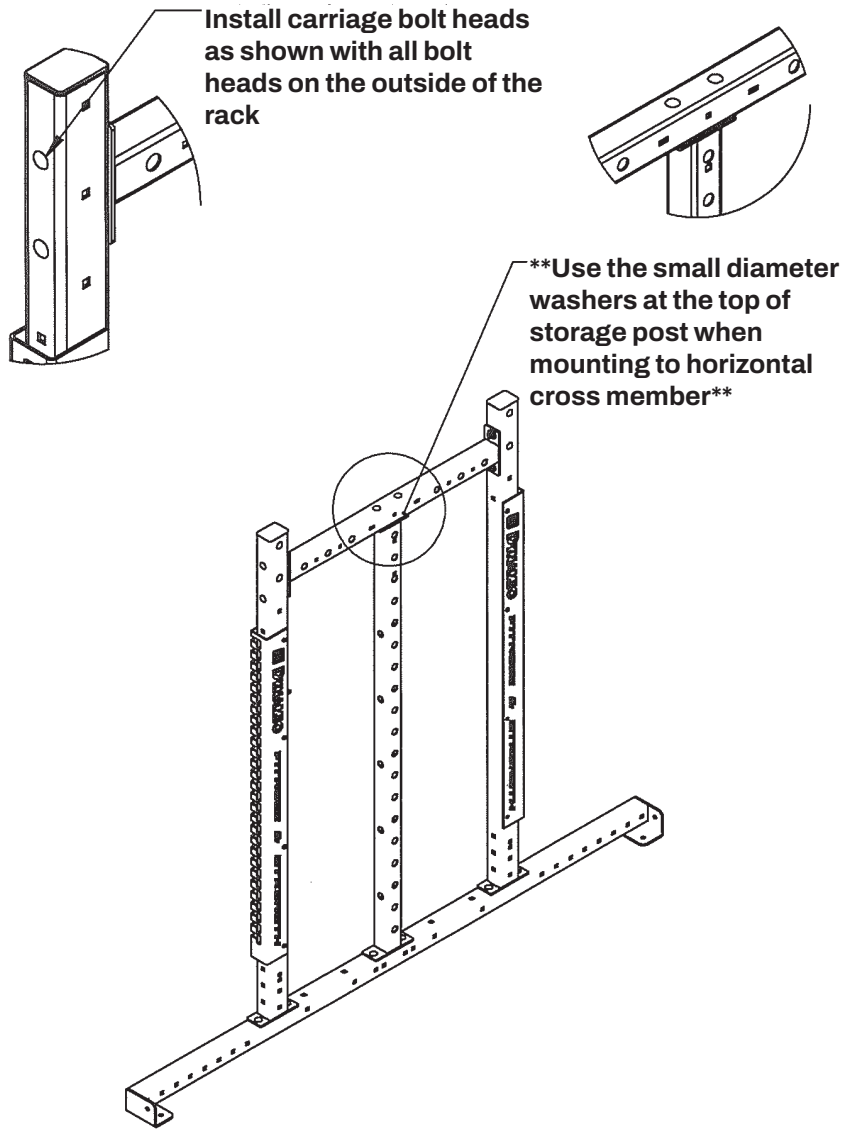

Step 3 A

Attach horizontal cross member to storage posts and front 8' uprights. Repeat for left side.

Note: Use small diameter washers at top plate when mounting storage post to horizontal

****Use the small diameter washers at the top of storage post when mounting to horizontal cross member****

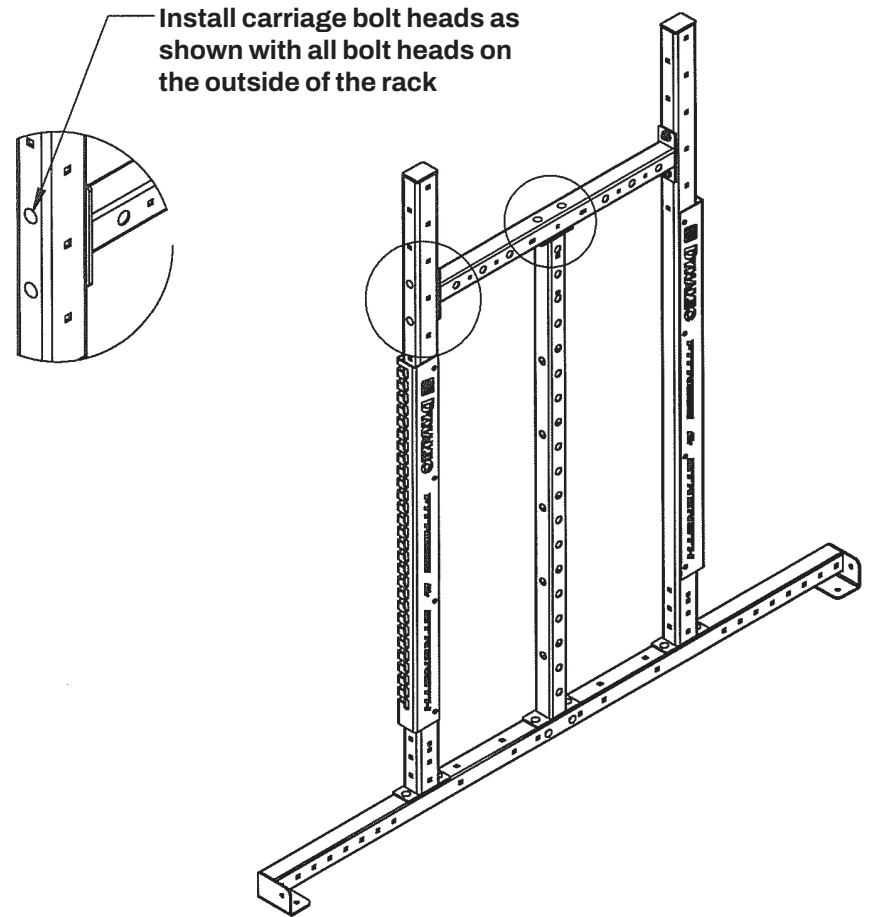

Step 3 B

Attach horizontal cross member to storage posts and front 9' uprights. Repeat for left side.

Note: Use small diameter washers at top plate when mounting storage post to horizontal.

**NOTE: Use 5" bolt on ULTRA PRO™
Use 4" bolt on TITAN G2**

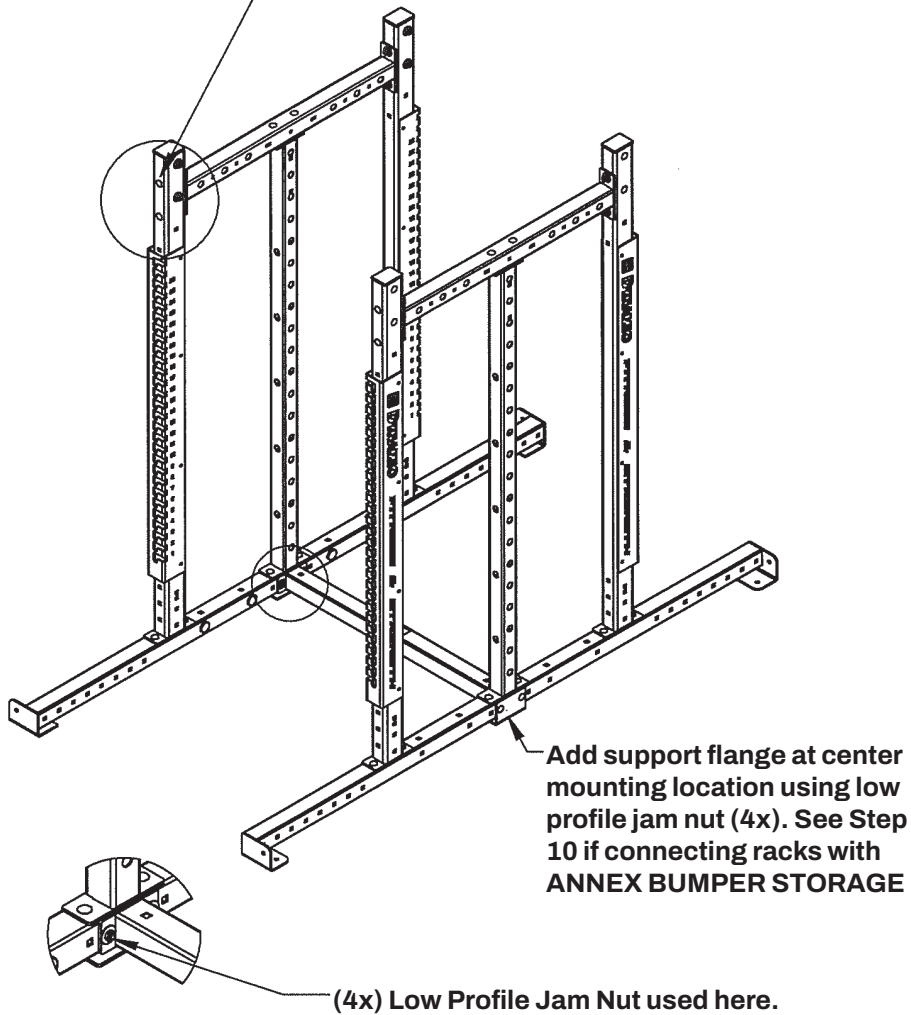

Step 4

Attach right half to left half as shown using horizontal base tube and center mounting flanges.

Note: The carriage bolt heads on outside of rack with low profile jam nut on inside.

**Note: Use 5" bolt on ULTRA PRO™
Use 4" bolt on TITAN G2**

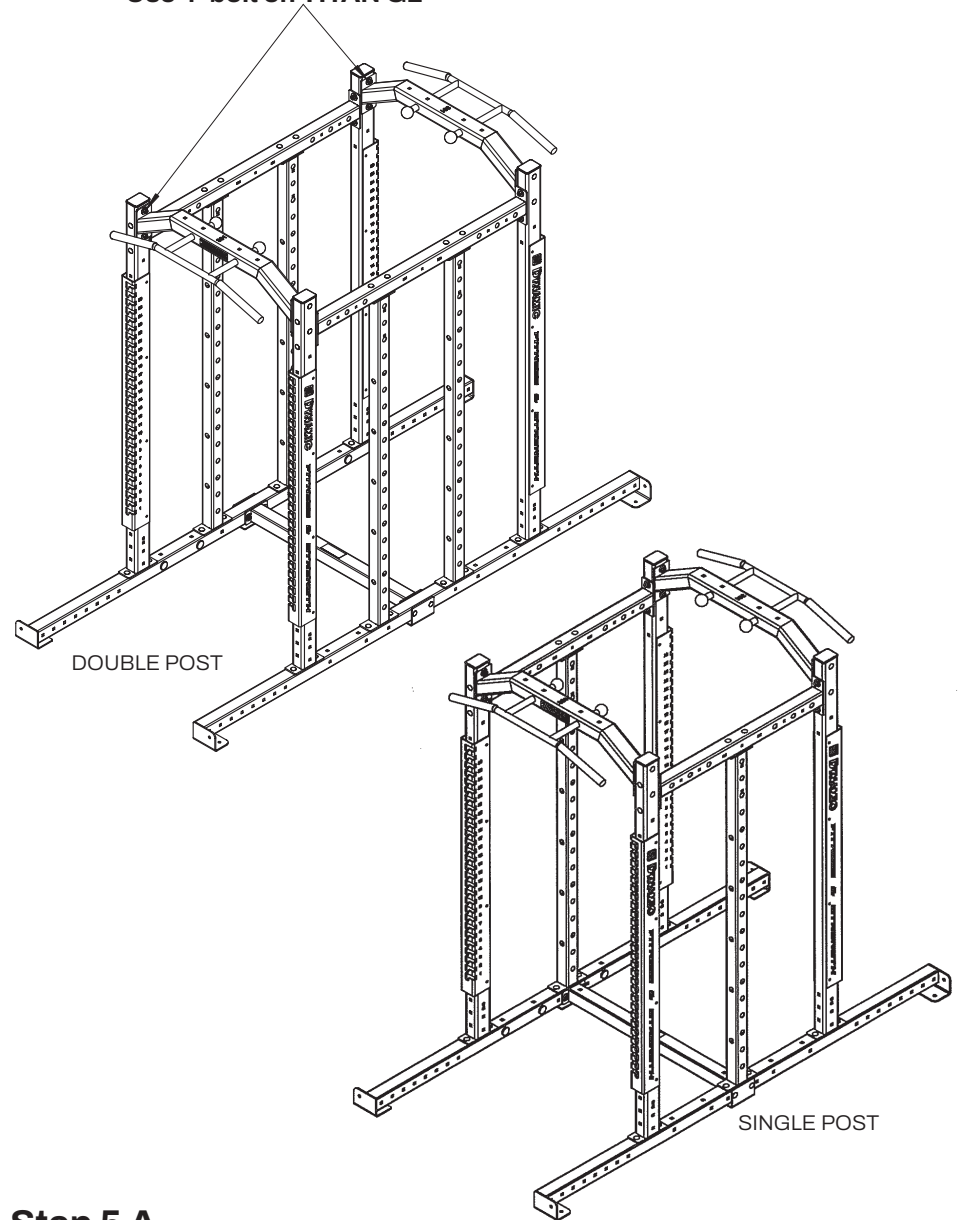

Step 5 A

Attach horizontal chin up bars between left and right 8' uprights as shown. This bar may vary based on your model.

Note: This step requires two people to lift and fasten.

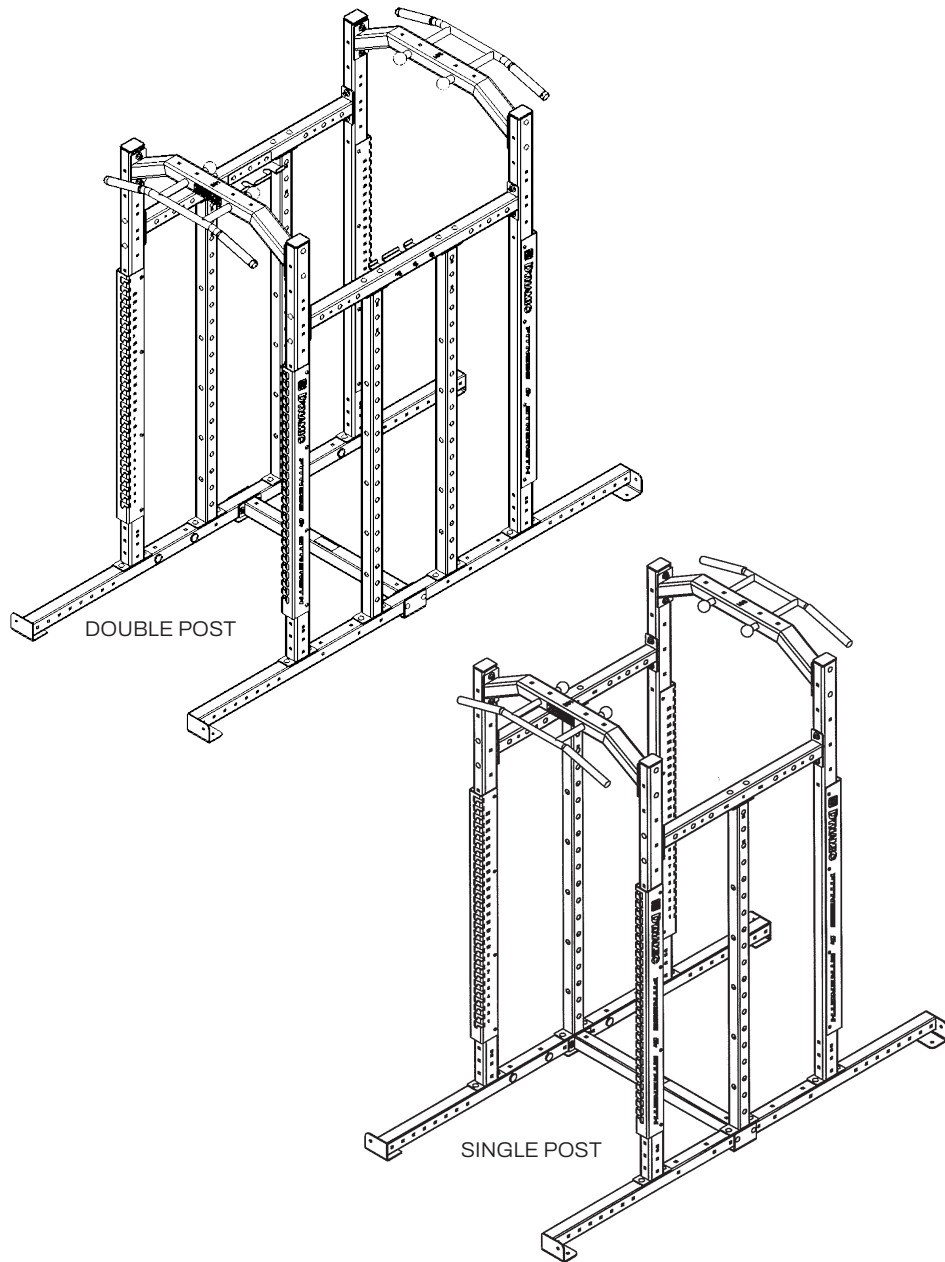

Step 5 B

Attach horizontal chin up bars between left and right 9' uprights as shown. This bar may vary based on your model.

Note: This step requires two people to lift and fasten.

Mount bar hanger to center of horizontal. Additional band hangers included with ULTRA PRO™ racks only

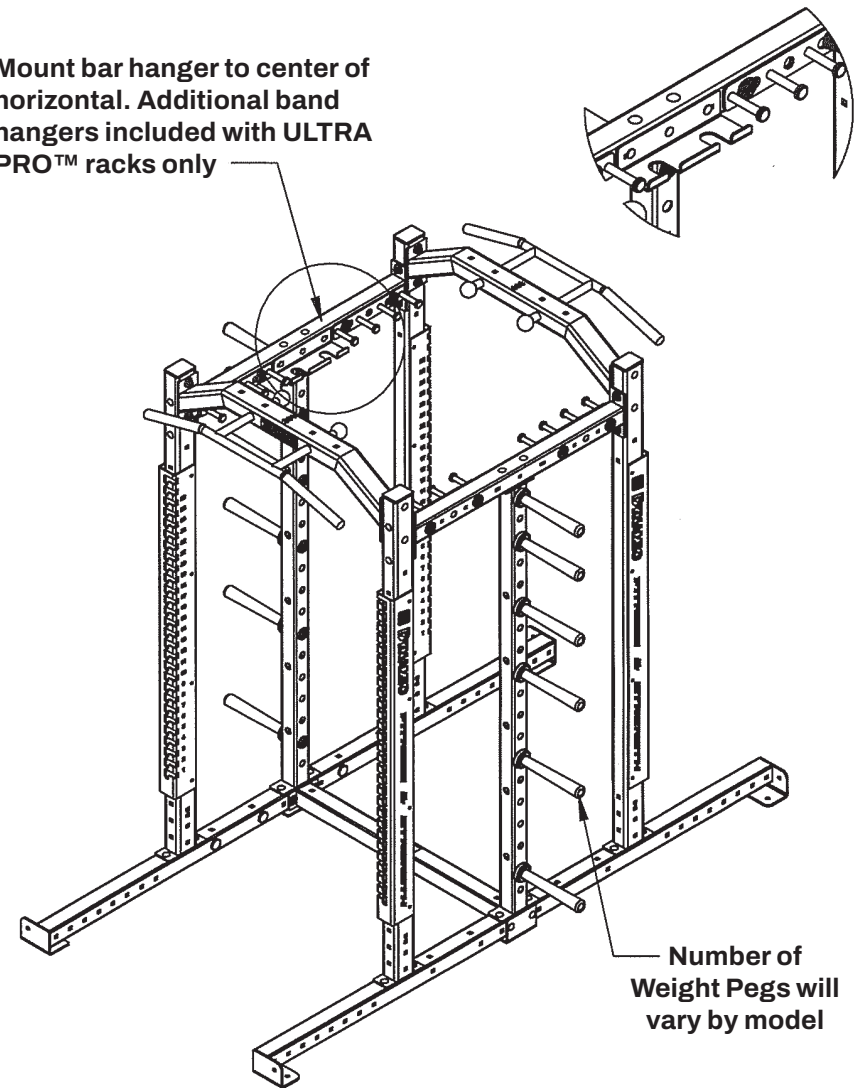

Step 6

Mount weight pegs in desired locations. The recommended spacing between each peg is (4) holes as shown. Install bar hangers and optional band storage hooks.

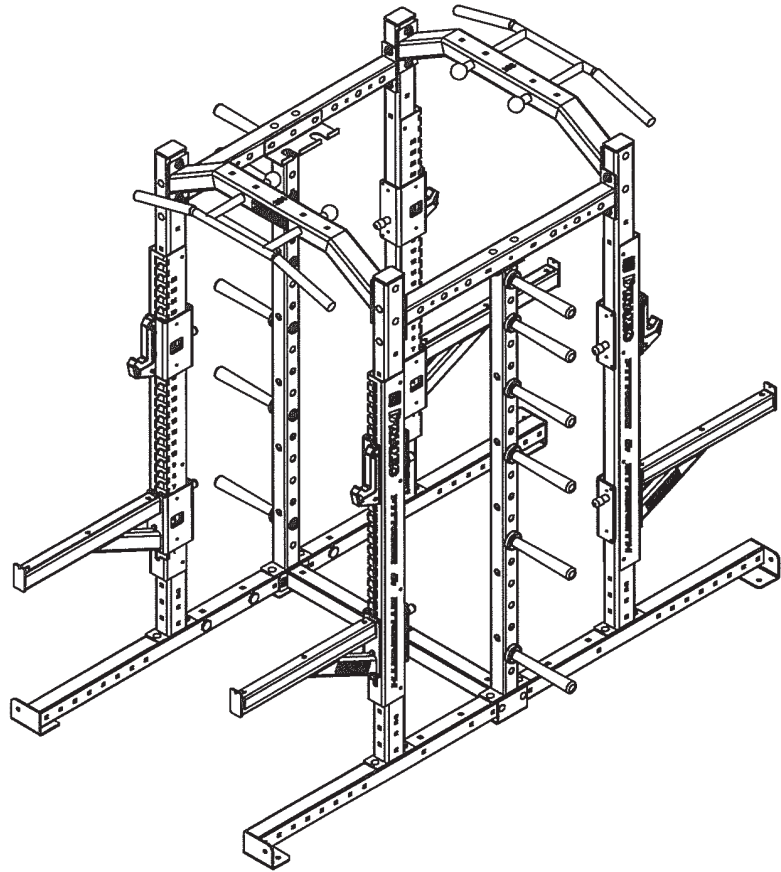

Step 7

Mount bar catch and safety assemblies to rack at desired location.

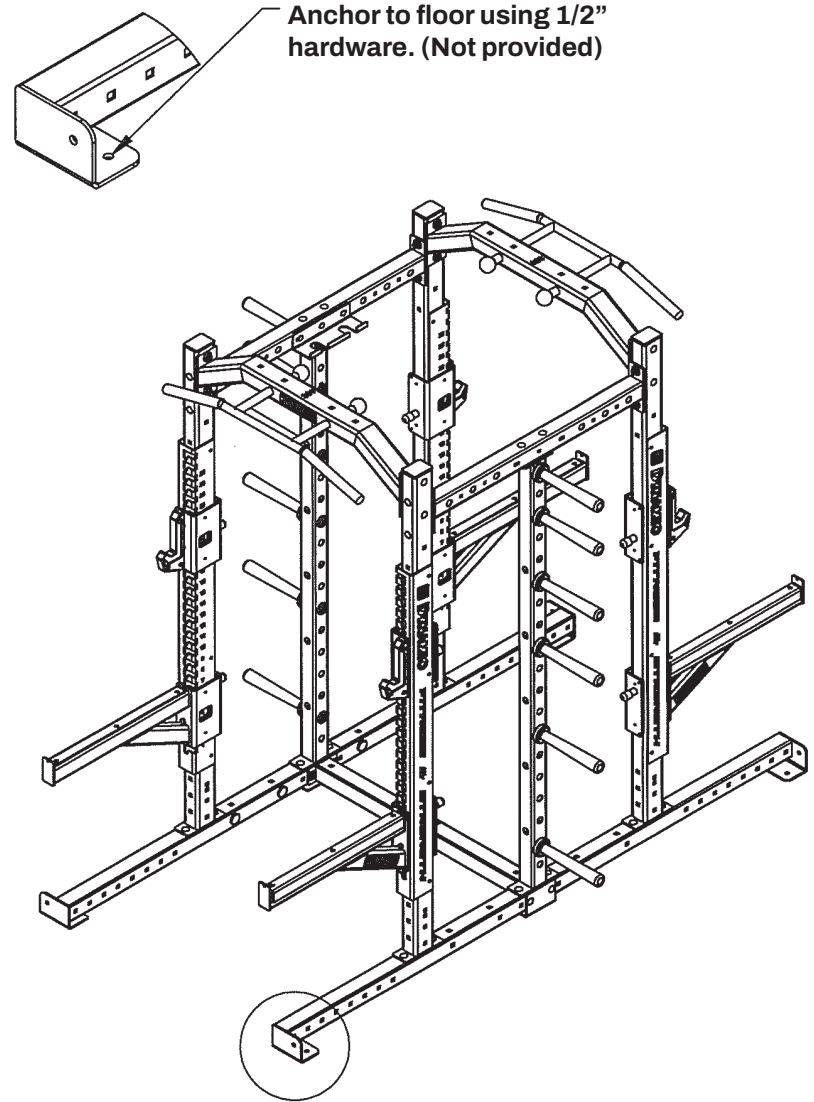

Step 8

Position rack in final location and anchor to floor using available holes on each base.

End of bolt **MUST** extend beyond nut face at all locations.

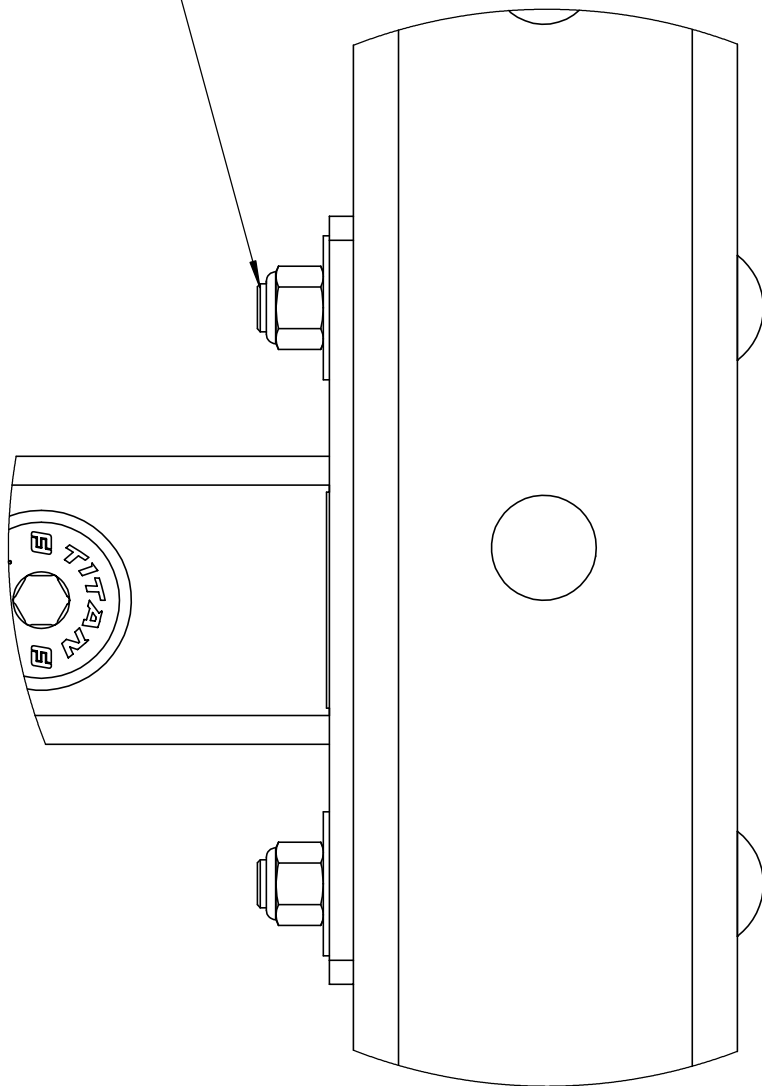

Step 9

Tighten each hardware connection. The end of each bolt should extend beyond nylock nut face as shown.

DO NOT COLLAPSE TUBING FROM OVER TIGHTENING HARDWARE.

Maintenance

Preventative actions will keep your facility safe and productive for all users

- 1) Wipe Down Equipment
Use general purpose cleaner.
Avoid Bleach based solutions.
- 2) Lubricate All Moving Parts
Use a silicone spray and clean rag to apply.
- 3) Tighten All Hardware
Inspect the condition of all hardware and tighten loose fasteners.
- 4) Inspect Wear Guards
To prevent metal to metal contact with components keep wear surfaces protected.
- 5) Replace All Worn Parts

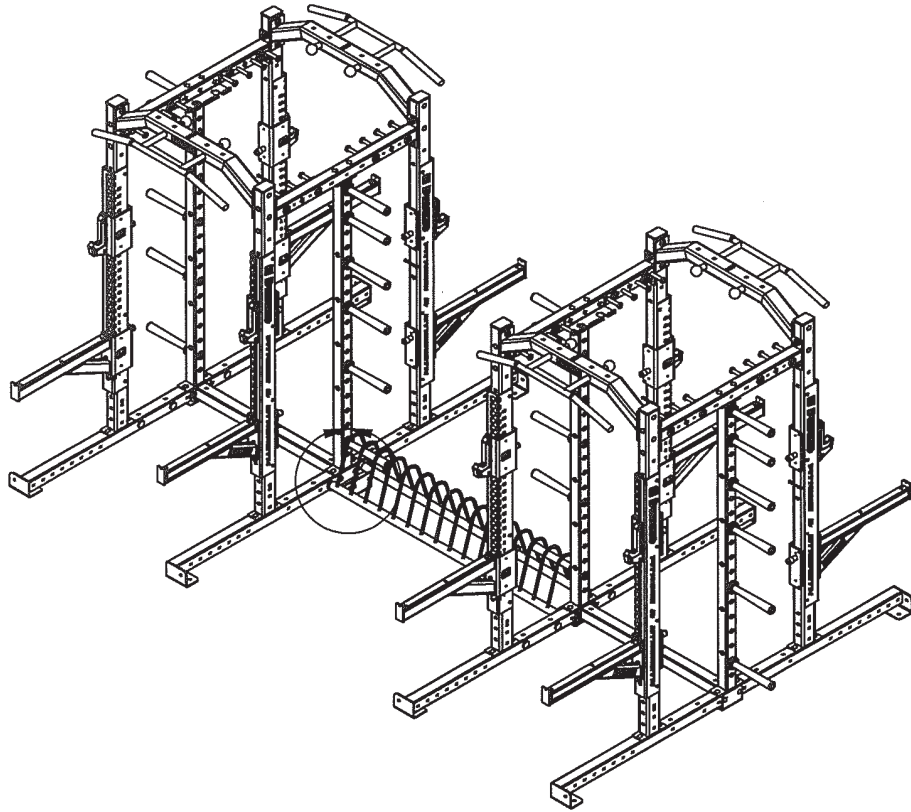

Step 10 (Optional)

Connecting Bumper Annex storage to single post rack center base support mounts inside storage rack, with flange facing inward.

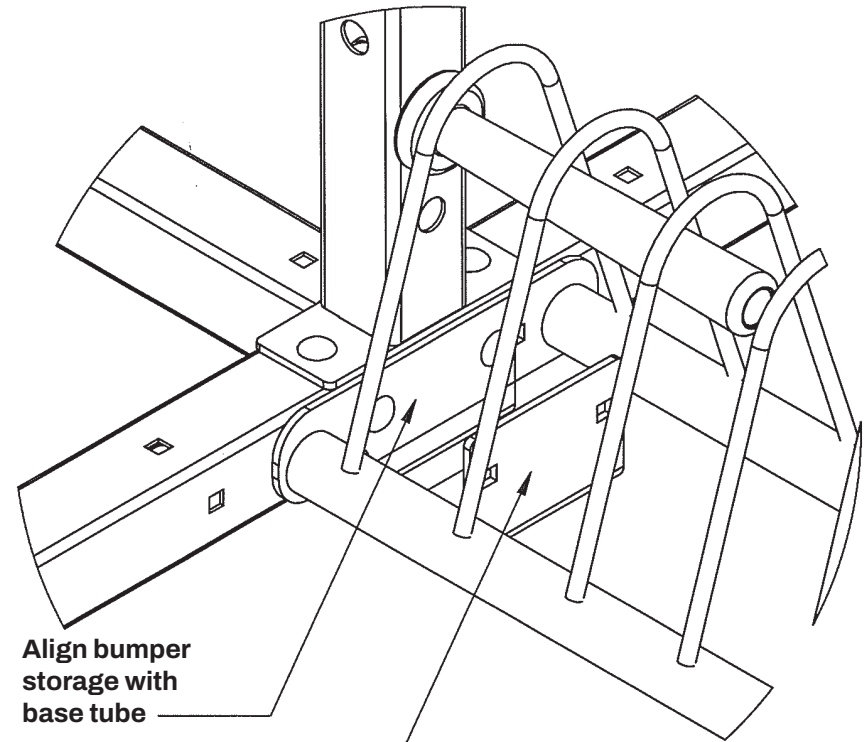

Align bumper storage with base tube

Align support flange with bumper storage plate. Insert bolt through all. Attach with low profile jam nut and 4-1/2" long carriage bolt. (BK-ANNEX7)

HARDWARE PACK CONTENTS
QUANTITIES VARY BY MODEL

**DOUBLE HALF RACK
SINGLE & DOUBLE POST
INSTRUCTION SHEET**

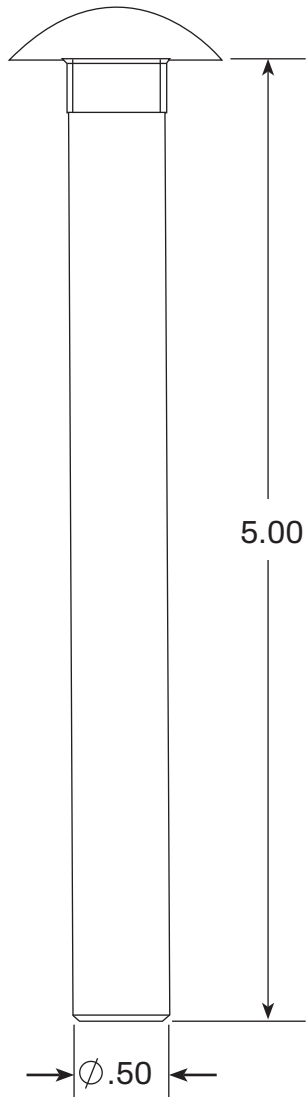

CAIR-500-002

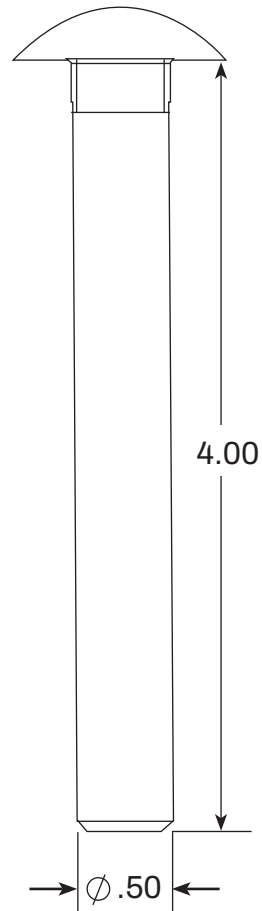

CAIR-500-001

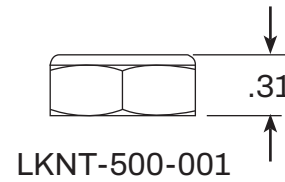

LKNT-500-001

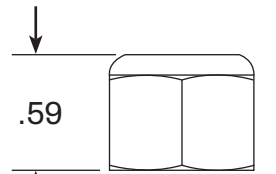

LKNT-500-002

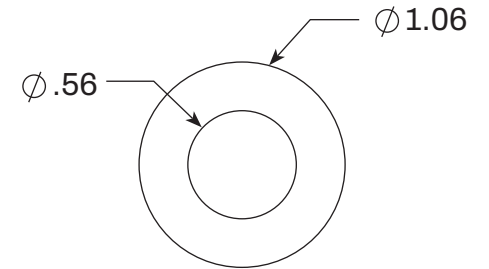

FLW-500-002

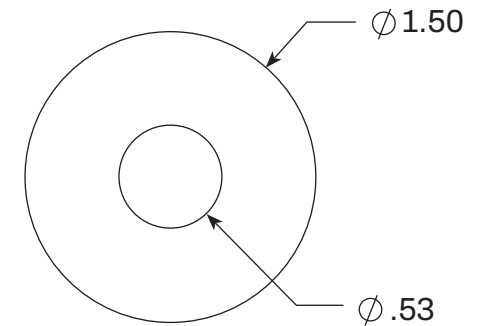

FLW-500-001

Tools Required:

(2) 1/2" Hex Key Wrench

TITAN PRO DOUBLE HALF RACK ASSEMBLY INSTRUCTIONS
SINGLE & DOUBLE POST

Models:

400515

400516

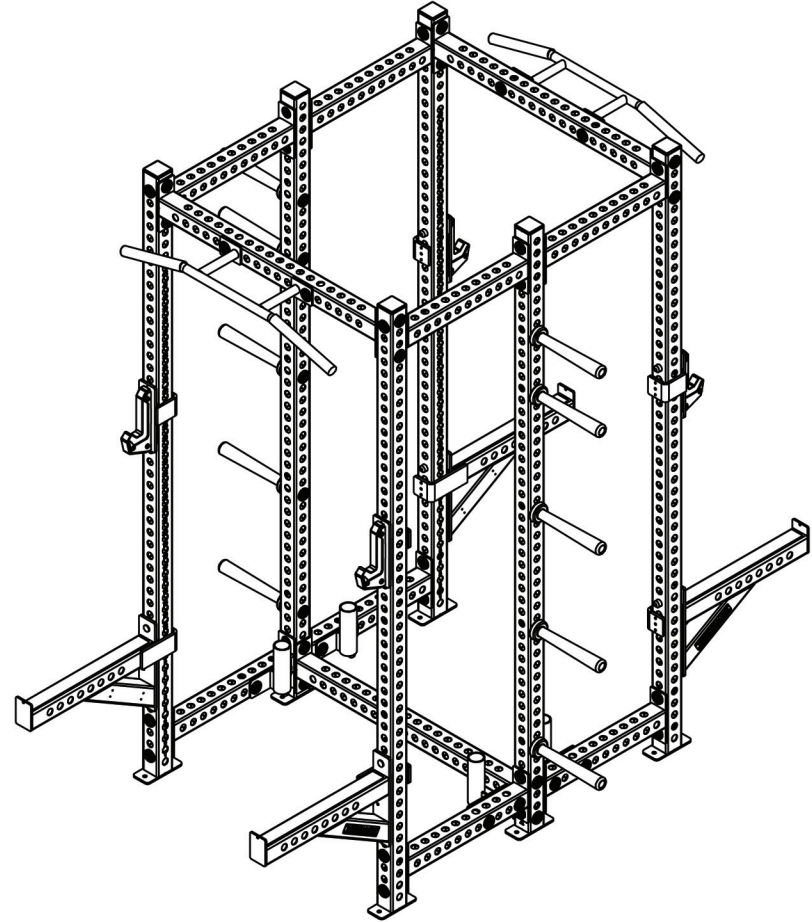
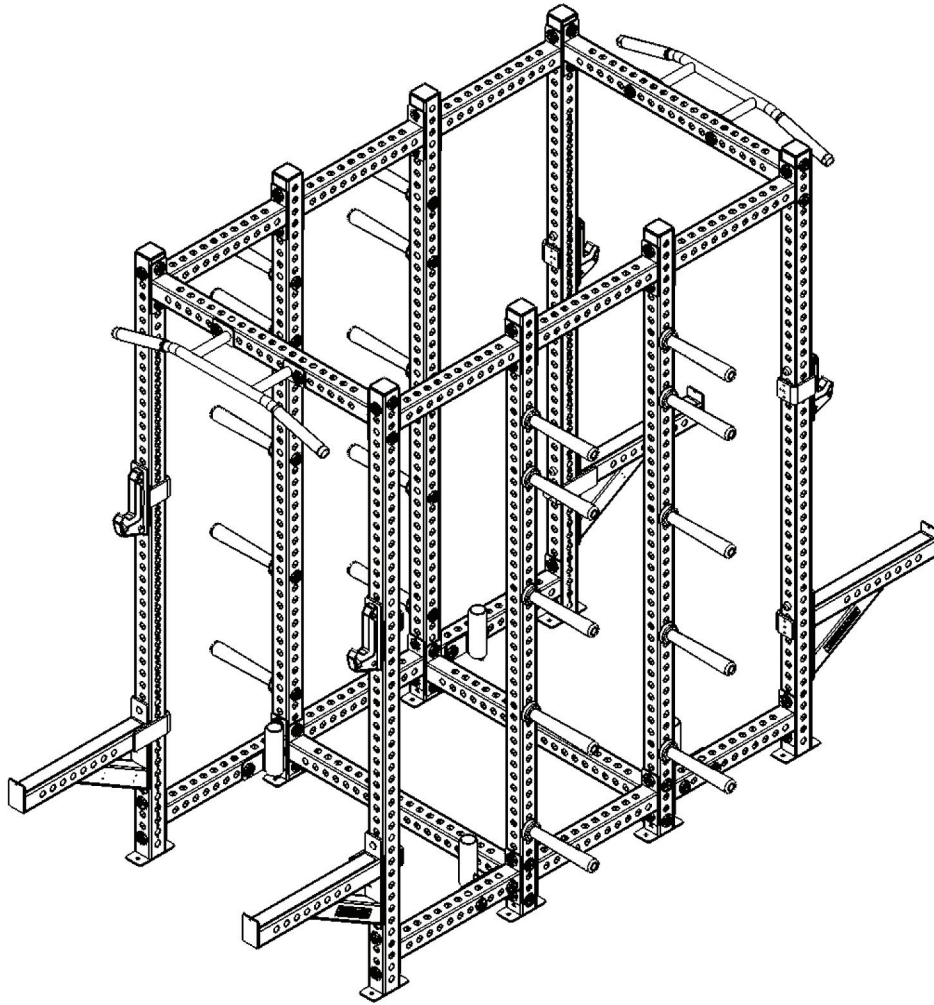

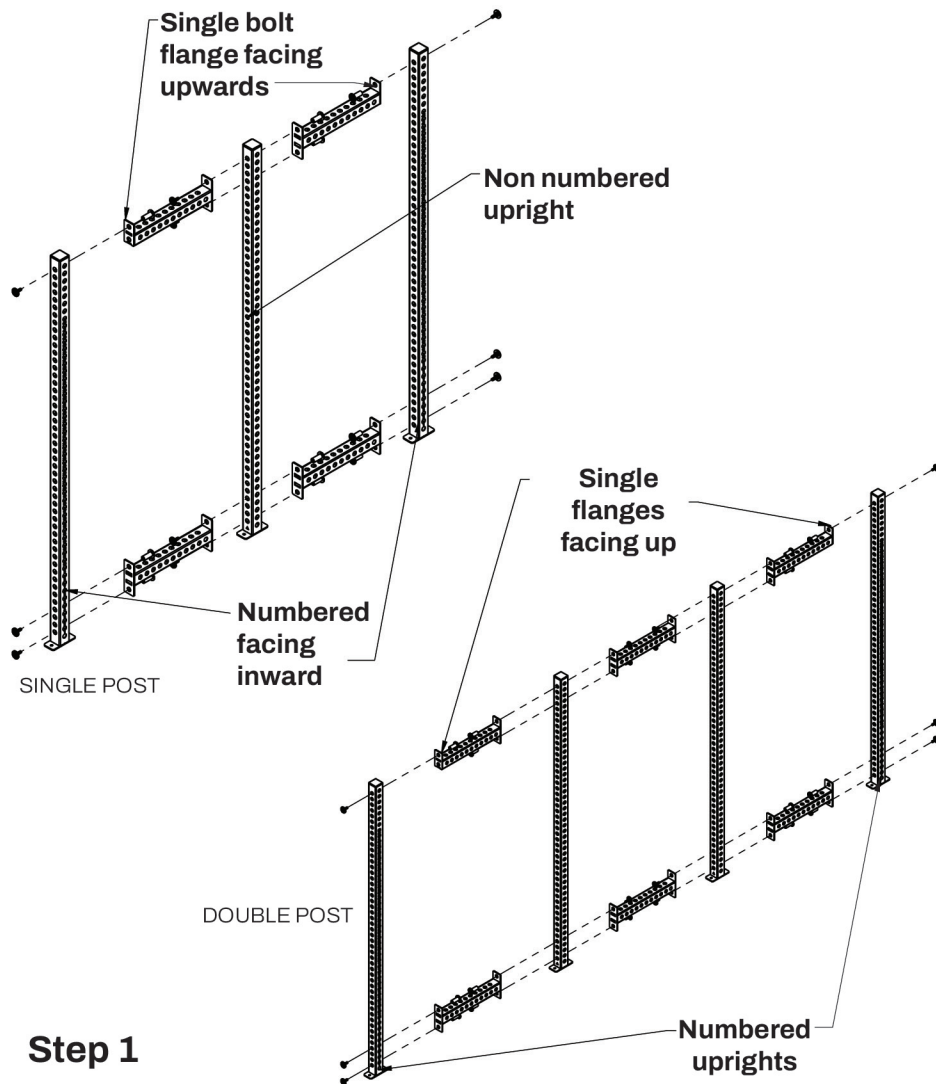

Step 1

Install the two uprights with laser cut numbers, and the center non numbered upright(s) together using 24" connectors. The lower connectors will have 2 bolt flanges on both ends, and the upper connectors will have a single bolt flange on one end. the single bolt flange will connect to the numbered uprights with the flange facing upwards as shown.

Repeat this step to create 2 side frames.

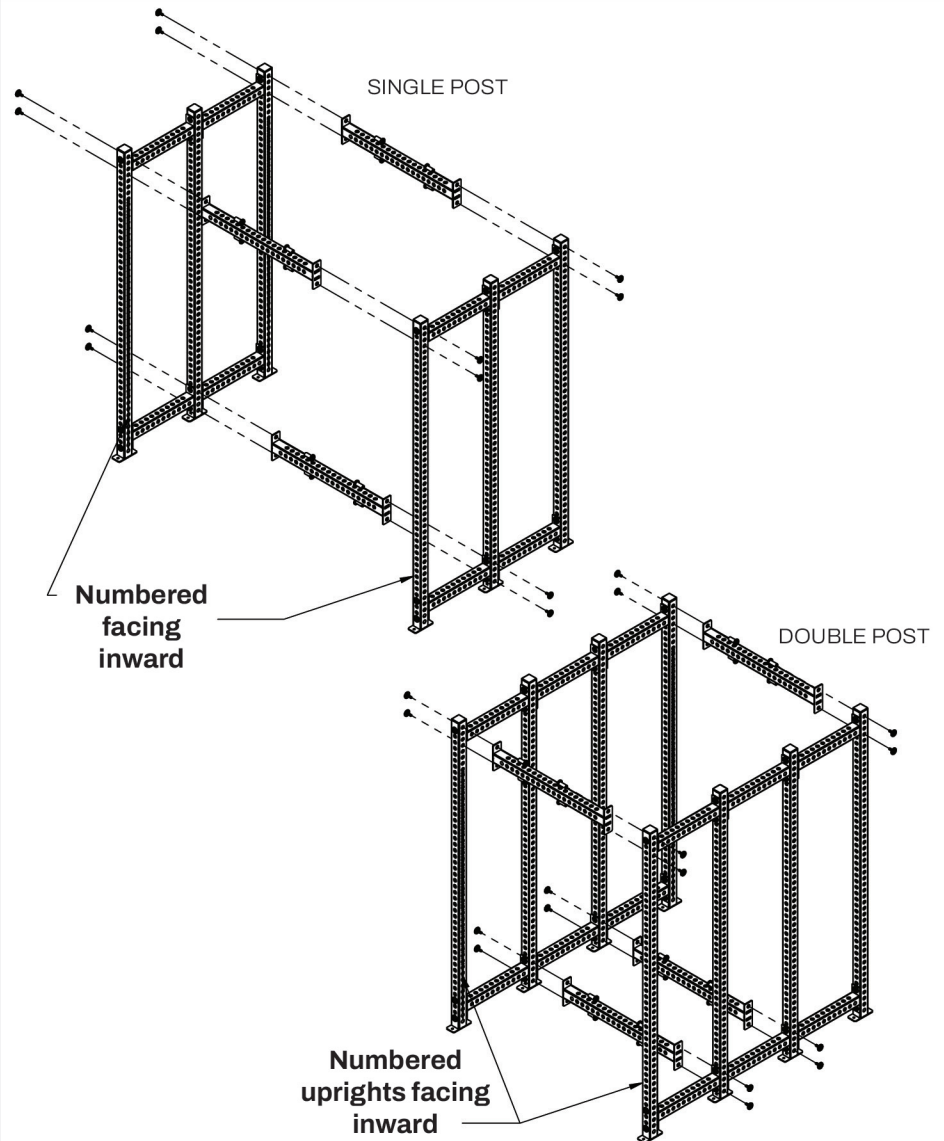

Step 2

Take 2 side frames from step one, making sure that both numbered sides are facing inward, and join together using 4-43" connectors. Connecting using the lowest possible holes on the center non numbered upright, and the highest 2 possible holes on the outer numbered uprights.

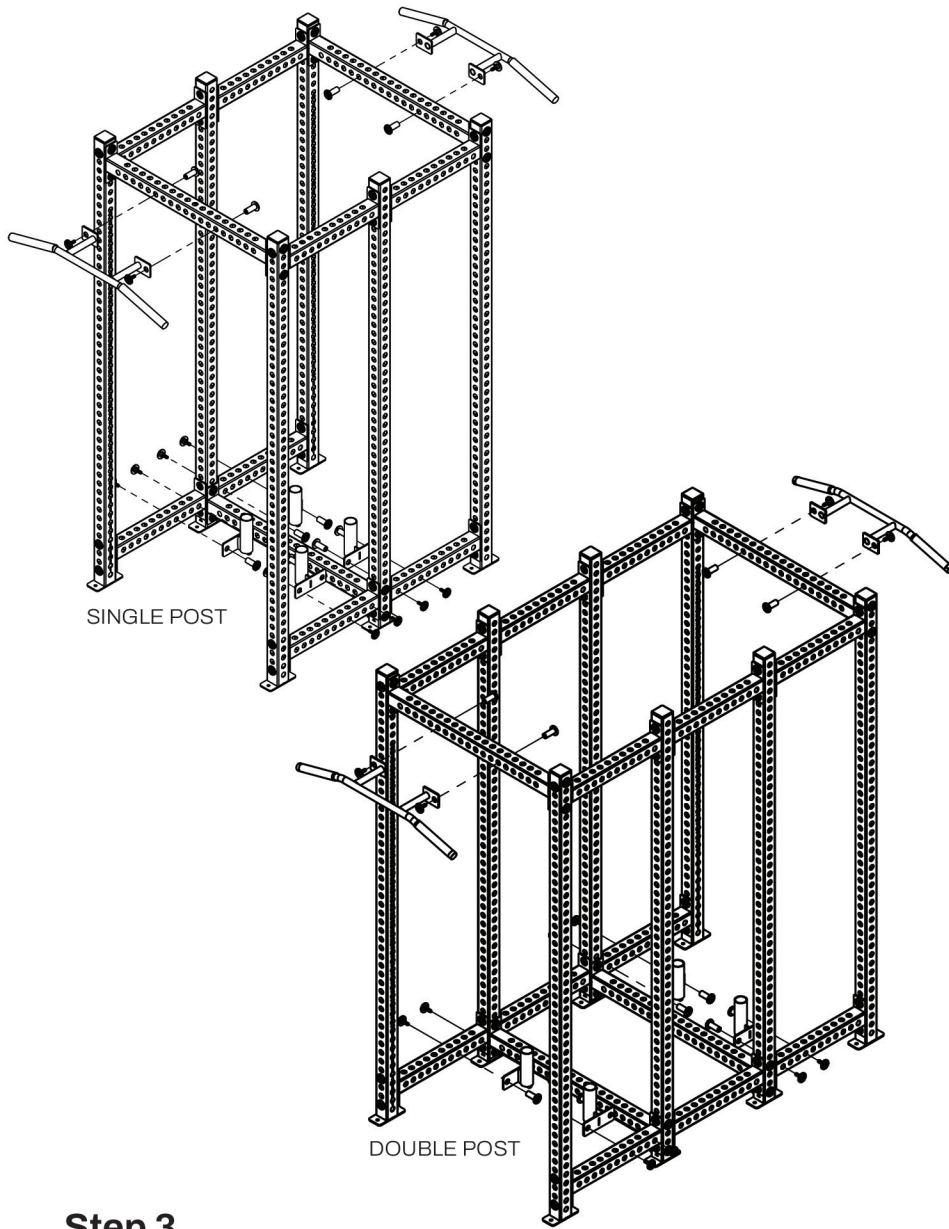

Step 3

Install 2 chin up bars onto center of the upper front connector as shown.

Install 4 bar holders at desired location, standard mounting location is shown.

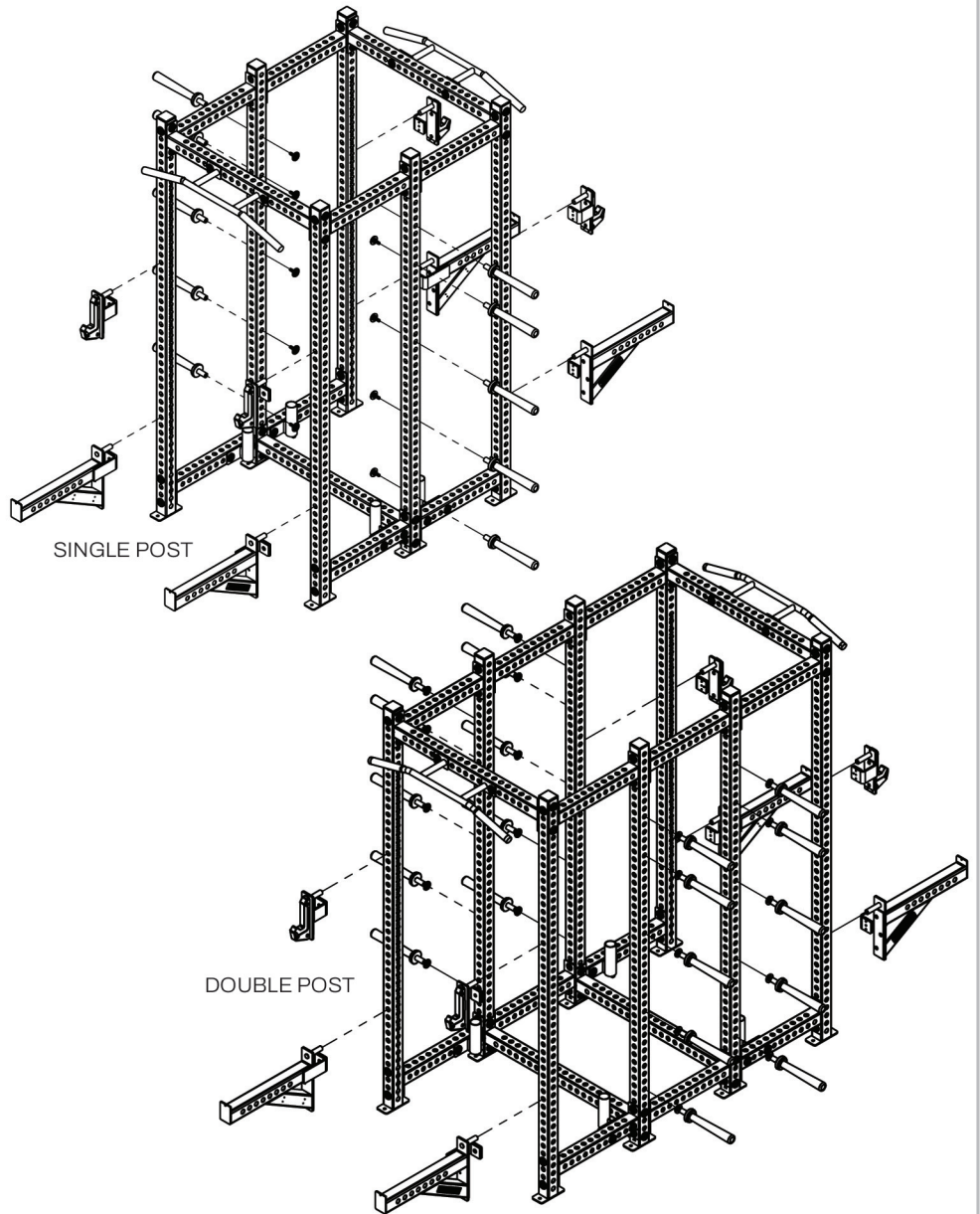

Step 4

Install safeties, J-cups and weight pegs at the desired location. Standard configuration shown.

Double check all hardware is tightened before use.